

SHANGHAI CIHPY INDUSTRY CO.,LTD.

CAST STEEL OR STAINLESS STEEL CF41 TYPE STEAM AND WATER SEPARATOR

MODEL NO: STDXRF-CF41

STEAM TRAP PRODUCT'S SIZE:

PRESSURE GRADE	FROM	TO
PN16/20	DN40	DN100



DESIGN DESCRIPTION:

- * QUICKLY CHANGE STEAM FLOW DIRECTION
- * FOR ISOLATING CONCENTRATING WATER
- * RESISTING WATERHAMMER.
- * DESIGN: FACTORY STANDARDS.
- * FLUID APPLICATION:
- * VAPOR, CONDENSATION, COMPRESSED AIR.
- * MEDIA MINIMUM TEMPERATURE: 25° C
- * END FLANGE: CLASS 150, PN 16, PN 20

MAXIMUM ALLOWABLE WORKING PRESSURE AND TEMPERATURE:

PRESSURE RATING	MAX WORKING PRSSURE	MAX WORKING TEMPERATURE
PN16	1.6Mpa	250 ⁰ C
PN20	2.0MPa	350 ⁰ C

TEST PRESSURE:

PN	SHELL (WATER)	SEAT (STEAM)
16	2.4MPA	1.6MPA
20	3.0MPA	1.6MPA

PARTS AND MATERIAL :

NO.	PARTS NAME	MATERIALS
1	WATCH NUT	ASTM A193 B7
2	BODY	ASTM A216-WCB OR ASTM A126
3	OUT WATER NUT	CARBON STEEL

OTHER MATERIALS ARE AVAILABLE UPON REQUEST.

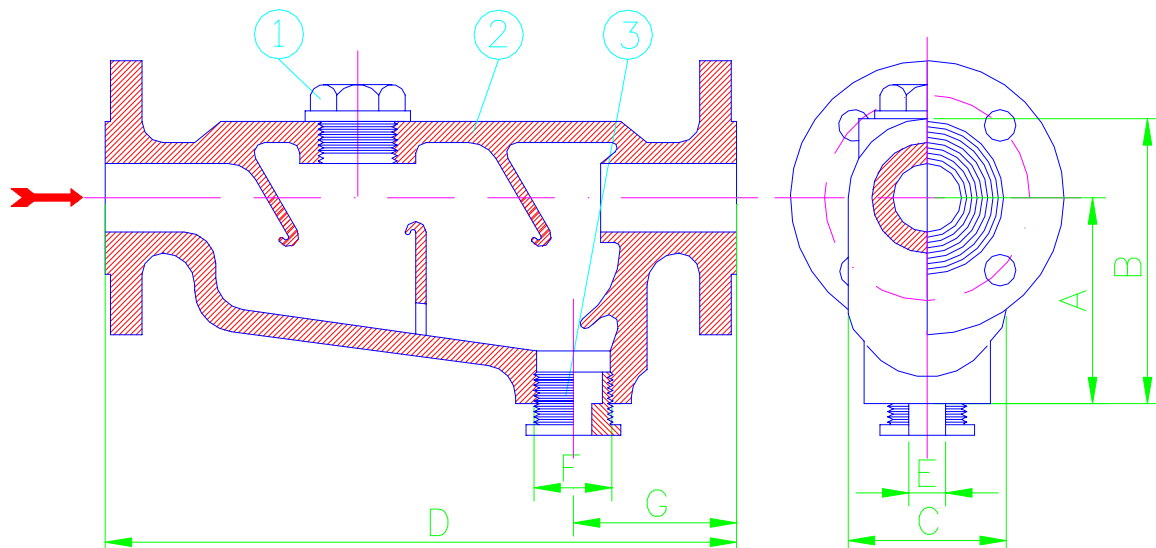

DIMENSIONS LIST(UNIT:mm):

DN	NPS	A	B	C	D	E	F	G
40	1-1/2"	111	156	89	365	1/2"	1-1/2"	94
50	2"	146	206	117	456	1/2"	1-1/2"	98
65	2-1/2"	184	232	146	456	3/4"	1-1/2"	98
80	3"	187	264	152	483	1"	1-1/2"	98
100	4"	208	337	197	508	1"	1-1/2"	118

*** We hereby reserve the rights of any alternative dimension that would help to improve our valve's quality and working efficiency**



SHANGHAI CIPHY INDUSTRY CO.,LTD
7G-1 Building, N0.515 Yishan Rd.
Shanghai, China
TEL:+86-21-5497 5962
FAX:+86-21-5497 5963
HTTP://WWW.CIPHY.CN
CIPHY@CIPHY.COM
COPYRIGHT©2004-[CIPHY]
ALL RIGHTS RESERVED