

# SHANGHAI CIPHY INDUSTRY CO.,LTD.

## ANSI CLASS 150/300/600/900

### CARBON STEEL OR STAINLESS STEEL

### SWING CHECK VALVE BOLTED BONNET DESIGN

**MODEL NO: SCAXRF-SW**



#### SWING CHECK VALVE PRODUCT'S SIZE:

PRESSURE GRADE	FROM	TO
CLASS 150	2"	16"
CLASS 300	2"	14"
CLASS 600	2"	12"

#### DESIGN DESCRIPTION:

- \* BOLTED COVER;
- \* FULLY GUIDER;
- \* INTEGRAL SEATS;
- \* SWING TYPE;
- \* NO OUT PIN FOR RESISTENT LEAK;
- \* FOR HORIZEONTAL OR VERTICAL LINES;
- \* FLANGED ENDS OR BUTT-WELDING ENDS;
- \* RISING FLANGE OR RING TYPE JOINT.

#### WORKING PRESSURE AND TEMPERATURE

WORKING TEMPERATURE		
MATERIAL	CELSIUR SCALE	FAHRENHEIT
CARBON STEEL	-290C~4250C	60F~8220F
STAINLESS STEEL	-400C~5500C	150F~10470F

#### GENERAL DESIGN SPECIFICATIONS:

ITEM	AMERICAN STANDARD	BRITISH STANDARD
MANUFACTURE	API 6D OR API 600	BS 1868
PRESSURE-TEMPERATURE RATINGS	ANSI B16.34	BS 1560
FACE TO FACE	ANSI B16.10	BS 2080
END TO END	ANSI B16.10	BS 2080
END FLANGE	ANSI B16.5	BS 1560
END BUTT-WELDING	ANSI B16.25	BS 1868
GASKET CONTACT	ANSI B16.5	BS 1560
INSPECTION AND TEST	API 598	BS 6755 PART 1

#### TEST PRESSURE TO API 598 OR BS 6755 PATRT 1

CLASS	SHELL (WATER)		SEAT (WATER)	
150	3.1MPA	450PSI	2.2MPA	315PSI
300	7.8MPA	1125PSI	5.6MPA	815PSI
600	15.3MPA	2225PSI	11.2MPA	1630PSI

#### TRIMS SPECITIED DUE TO TABLE 3:

DISC SEAT SURFACE PART NO.3	BODY SEAT SURFACE PART NO.2	PIN PART NO.7
F6	F6	F6
STELLITE	STELILITE	F6
F6	STELILITE	F6
304	304	F304
316	316	F316
304L	304L	F304L
316L	316L	F316L

OTHER MATERIALS ARE AVAILABLE UPON REQUEST.

**PARTS AND MATERIAL (ASTM)**

NO	PARTS NAME	MATERIAL				
1	BODY	A216-WCB	A351-CF8	A351-CF8M	A351-CF3	A351-CF3M
4	SWING ARM	A216-WCB	A351-CF8	A351-CF8M	A351-CF3	A351-CF3M
5	DISC NUT	410	316	316	316	316
6	DISC O-RING	410	316	316	316	316
8	PLUG	A216-WCB	A351-CF8	A351-CF8M	A351-CF3	A351-CF3M
9	COVER BOLTED NUT	A1942H	A193B8	A193B8	A193B8	A193B8
10	COVER BOLT	A193B7	A193B8	A193B8	A193B8	A193B8
11	PLUG NUT	410	316	316	316	316
12	GASKET	REINFORCED FLAT GRAPHITE,OR SS SPIREAL WOUND W/GRAPHITE OR PTFE,OR REINFORCEPTFE				
13	COVER	A216-WCB	A351-CF8	A351-CF8M	A351-CF3	A351-CF3M
14	HOOK SCREW	STEEL				

OTHER MATERIALS ARE AVAILABLE UPON REQUEST.

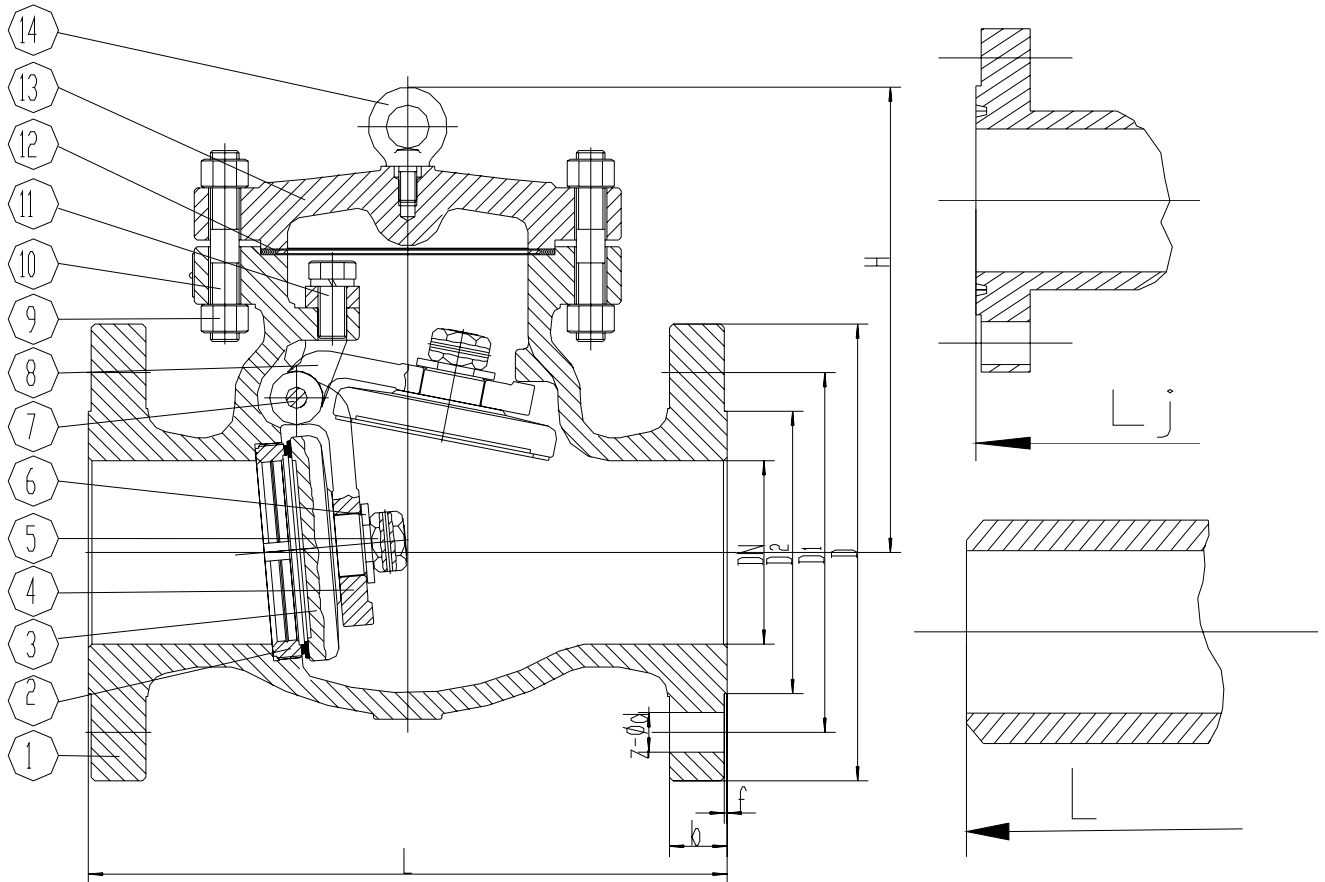

**DIMENSIONS LIST(UNIT:inch):**

CLASS 150 CHECK VALVE FLANGE END AND WELDING END

DN	NPS	F(mm)	L	LJ	D	D1	D2	b	Z-Φd	H	Wt (kg)
50	2	2.1	8	8-1/2	6	4-3/4	3-5/8	5/8	4-3/4	6-1/4	17
65	2-1/2	2.1	8-1/2	9	7	5-1/2	4-1/8	11-16	4-3/4	6-5/8	25
80	3	2.1	9-1/2	10	7-1/2	6	5	3/4	4-3/4	7-1/8	29
100	4	2.1	11-1/2	12	9	7-1/2	6-3/16	15/16	8-3/4	8	50
150	6	2.1	14	14-1/2	11	9-1/2	8-1/2	1	8-7/8	10-7/8	85
200	8	2.1	19-1/2	20	13-1/2	11-3/4	10-5/8	1-1/8	8-7/8	13	150
250	10	2.1	24-1/2	25	16	14-1/4	12-3/4	1-3/16	12-1	15	240
300	12	2.1	27-1/2	28	19	17	15	1-1/4	12-1	16-1/8	350
350	14	2.1	31	31-1/2	21	18-3/4	16-1/4	1-3/8	12-1-1/8	20-5/8	460
400	16	2.1	34	34-1/2	23-1/2	21-1/4	18-1/2	1-7/16	16-1-1/8	22-1/2	495

CLASS 300 FLANGE END AND WELDING END

50	2	2.1	10-1/2	11-1/8	6-1/2	5	3-5/8	7/8	8-3/4	6-7/8	28
65	2-1/2	2.1	11-1/2	12-1/8	7-1/2	5-7/8	4-1/8	1	8-7/8	7-1/8	33
80	3	2.1	12-1/2	13-1/8	8-1/4	6-5/8	5	1-1/8	8-7/8	7-1/2	45
100	4	2.1	14	14-5/8	10	7-7/8	6-3/16	-1/4	8-7/8	9-1/2	70
150	6	2.1	17-1/2	18-1/8	12-1/2	10-5/8	8-1/2	1-7/16	12-7/8	12	150
200	8	2.1	21	21-5/8	15	13	10-5/8	1-5/8	12-1	14-1/4	230
250	10	2.1	24-1/2	25-1/8	17-1/2	15-1/4	12-3/4	1-7/8	16-1-1/8	16-1/4	390
300	12	2.1	28	28-5/8	20-1/2	17-3/4	15	2	16-1-1/4	17-3/4	520
350	14	2.1	33	33-5/8	23	20-1/4	16-1/4	2-1/8	20-1-1/4	21-5/8	710

## CLASS 600 FLANGE END AND WELDING END

50	2	6.4	11-1/2	11-5/8	6-1/2	5	3-5/8	1	8-3/4	8	32
65	2-1/2	6.4	13	13-1/8	7-1/2	5-7/8	4-1/8	1-1/8	8-7/8	8-5/8	42
80	3	6.4	14	14-1/8	8-1/4	6-5/8	5	1-1/4	8-7/8	9-3/8	60
100	4	6.4	17	17-1/8	10-3/4	8-1/2	6-3/16	1-1/2	8-1	11	110
150	6	6.4	22	22-1/8	14	11-1/2	8-1/2	1-7/8	12-1-1/8	15	220
200	8	6.4	26	26-1/8	16-1/2	13-3/4	10-5/8	2-3/16	12-1-1/4	17-1/4	390
250	10	6.4	31	31-1/8	20	17	12-3/4	2-1/2	16-1-3/8	20-3/4	630
300	12	6.4	33	33-1/8	22	19-1/4	15	2-5/8	20-1-3/8	25-1/4	870

**\* We hereby reserve the rights of any alternative dimension that would help to improve our valve's quality and working efficiency**



**SHANGHAI CIPHY INDUSTRY CO.,LTD**  
**7G-1 Building, N0.515 Yishan Rd.**  
**Shanghai, China**  
**TEL:+86-21-5497 5962**  
**FAX:+86-21-5497 5963**  
**HTTP://WWW.CIPHY.CN**  
**CIPHY@CIPHY.COM**  
**COPYRIGHT©2004-[CIPHY]**  
**ALL RIGHTS RESERVED.**