

SHANGHAI CIPHY INDUSTRY CO.,LTD.

ANSI 1000WOG

CARBON STEEL OR STAINLESS STEEL

2-PC BALL VALVE BOLTED CAP DESIGN

MODEL NO: SLAXTH-2P



BALL VALVE PRODUCT'S SIZE:

PRESSURE GRADE	FROM	TO
ANSI 1000WOG	1/4"	4"



DESIGN DESCRIPTION:

- * BOLTED CAP, 2-PC
- * INVESTMENT CASTING BODY
- * BLOW-OUT PROOF STEM DESIGN
- * CONECTRION: THREADED ENDS
- * THREAD TYPE(ANSI,DIN,BS)

WORKING PRESSURE AND TEMPERATURE

WORKING TEMPERATURE		
MATERIAL	CELSIUR SCALE	FAHRENHEIT
CARBON STEEL	-29°C~425°C	6°F~822°F
STAINLESS STEEL	-40°C~550°C	15°F~1047°F

GENERAL DESIGN SPECIFICATIONS:

ITEM	ANSI 1000WOG
MANUFACTURE	FACTORY STANDARDS
PRESSURE-TEMPERATURE RATINGS	ANSI B16.34
END THREAD	Npt , din , bsp , jis
INSPECTION AND TEST	API 598

TEST PRESSURE TO API 598

ANSI	SHELL (WATER)		SEAT (WATER)		SEAT (AIR)	
1000	10.5MPA	1500PSI	7.7MPA	1100PSI	0.6MPA	80PSI

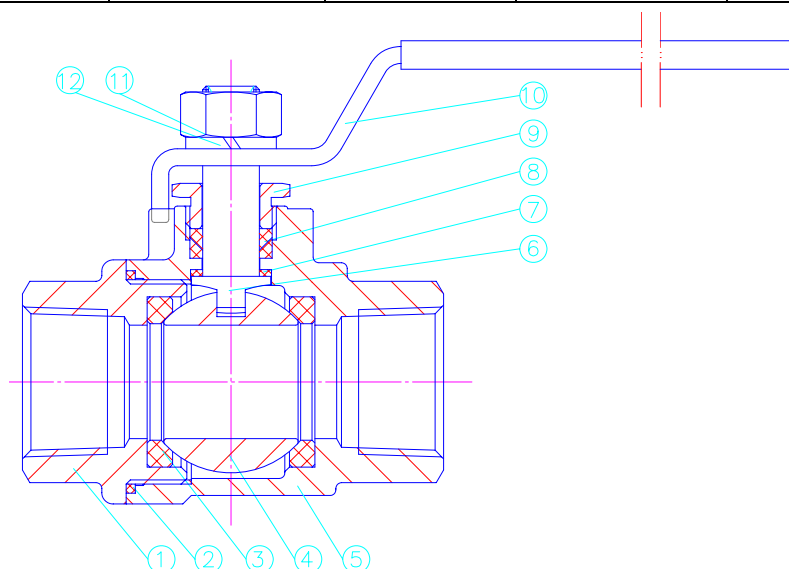

PARTS AND MATERIAL (ASTM)

NO.	PART NAME	MATERIAL
1	END CAP	ASTM A216-WCB, A351-CF8/CF8M
2	GASKET	PTFE
3	SEAT	PTFE
4	SOLID BALL	ASTM A351-CF8/CF8M
5	BODY	ASTM A216-WCB, A351-CF8/CF8M
6	STEM	SS316/SS304
7	THRUST WASHER	PTFE
8	STEM PACKING	PTFE
9	GLAND NUT	SS 304
10	HANDLE	CARBON STEEL/SS 304
11	HALF-WASHER	SS 304
12	HANDLE NUT	SS 304

OTHER MATERIALS ARE AVAILABLE UPON REQUEST.

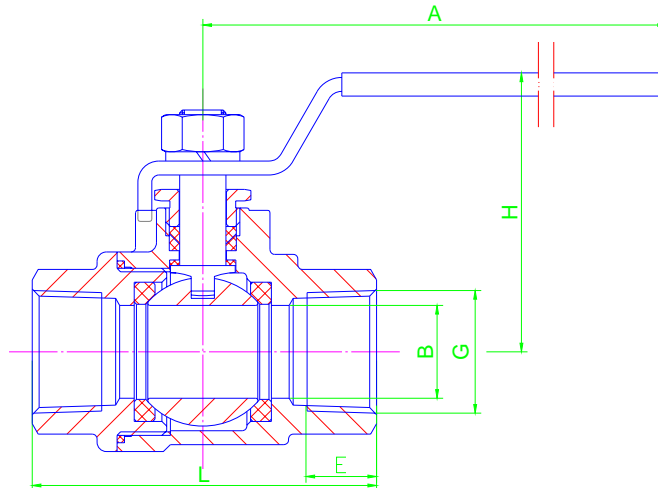
**DIMENSIONS LIST(UNIT:MM):**

DN	Size	B	L	H	A	E
6	1/4"	8	54	52	105	11.5
10	3/8"	10	54	52	105	11.5
15	1/2"	15	62.5	65	130	14
20	3/4"	20	73.5	70	130	15
25	1"	25	86	78	150	15
32	1-1/4"	32	101	82	180	18
40	1-1/2"	38	110	90	200	19
50	2"	50	123	98	200	19
65	2-1/2"	64	165	140	240	23
80	3"	80	190	135	260	25
100	4"	100	220	170	300	28

*** We hereby reserve the rights of any alternative dimension that would help to improve our valve's quality and working efficiency**



SHANGHAI CIPHY INDUSTRY CO.,LTD
7G-1 Building, N0.515 Yishan Rd.
Shanghai, China
TEL:+86-21-5497 5962
FAX:+86-21-5497 5963
HTTP://WWW.CIPHY.CN
CIPHY@CIPHY.COM
COPYRIGHT©2004-[CIPHY]
ALL RIGHTS RESERVED.